

# MANUAL

## LOCKING CLIP

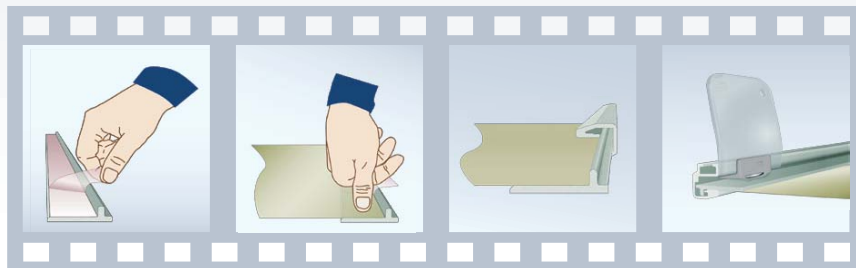

PORTABLE DISPLAYS

1

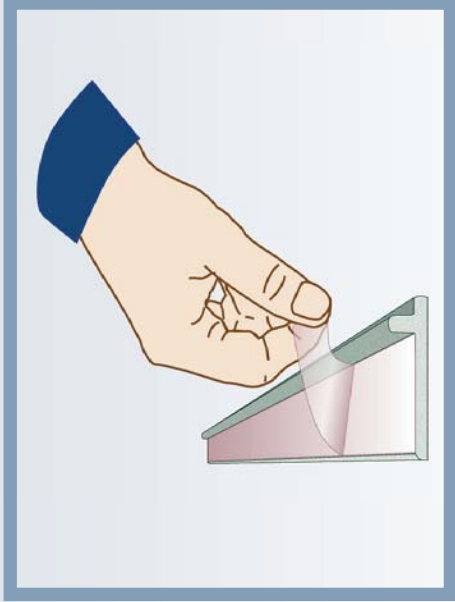

Remove a small part of the protective liner on the tape.

2

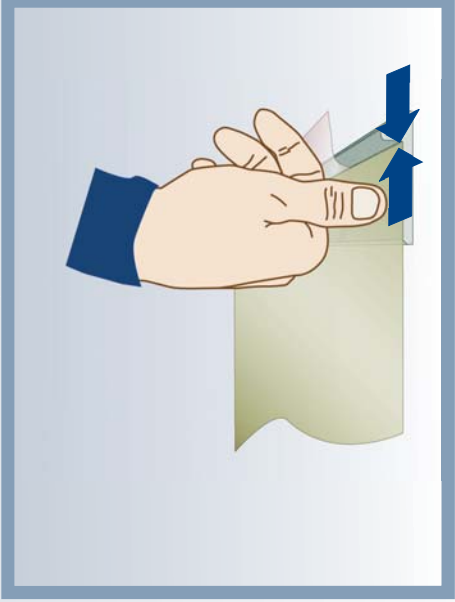

Adjust the image towards the strip and fix it to the panel strip.

3

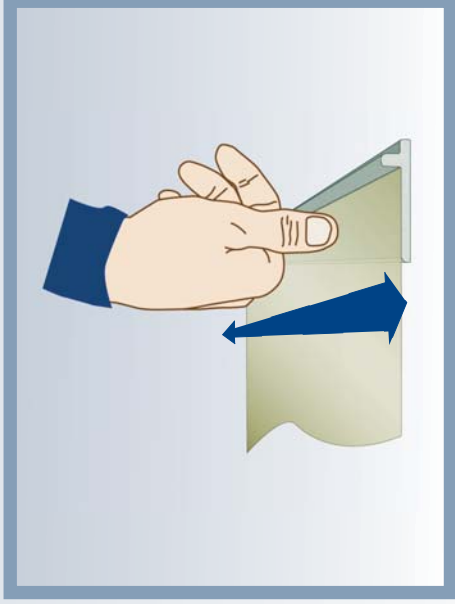

Remove the remaining part of the protective liner and press the image firmly onto the panelstrip.

4

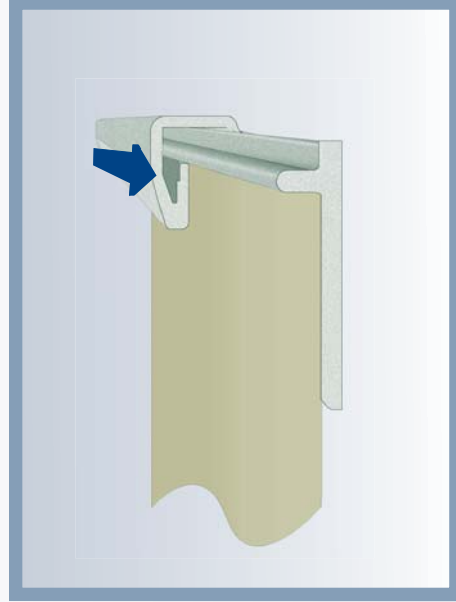

Slide the top profile onto the image.

5

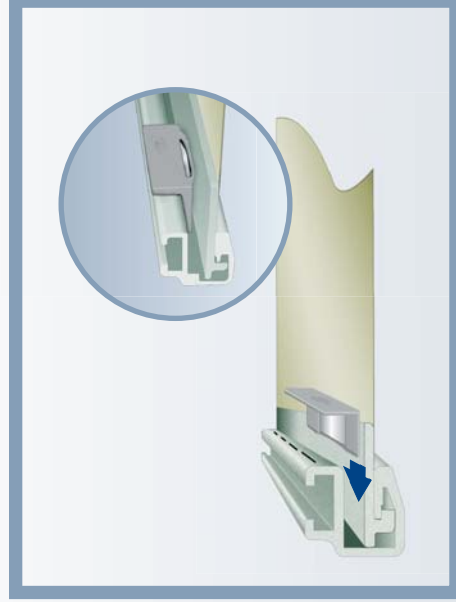

Turn the image around and push the clips into the places marked with a black line at the top profile.

6



Use the Expolinc tool (or similar) to remove the locking clip when changing the image.

